

ACCORDING TO THE OFFICIAL FLOOD INSURANCE RATE MAPS, THIS PROPERTY IS NOT IN AN AREA HAVING SPECIAL FLOOD HAZARDS.

THE FIELD DATA UPON WHICH THIS PLAT IS BASED HAS A CLOSURE PRECISION OF ONE FOOT IN 10,000+ FEET AND AN ANGULAR ERROR OF 2" PER ANGLE AND WAS ADJUSTED USING THE COMPASS RULE.

EQUIPMENT = TOPCON GTS 303D TOTAL STATION

E.C. PLAT = 1/252,474 FT.

N/F GRW PARTNERSHIP
DEED BOOK 685, PAGE 529

LL 1162 LL 1163

N 89°20'00"E

194.80'

AREA = 1.136 ACRES

S 00°40'00"E
207.00'

S 00°40'00"E
23.00'

101.30'

S 89°20'00"W
136.13'

S 89°20'00"W

N/F DONNIE E. PERRY
DEED BOOK 1824, PAGE 73

N/F ARTHUR GUILFOIL
BOBBY ROGERS
DEED BOOK 987, PAGE 30

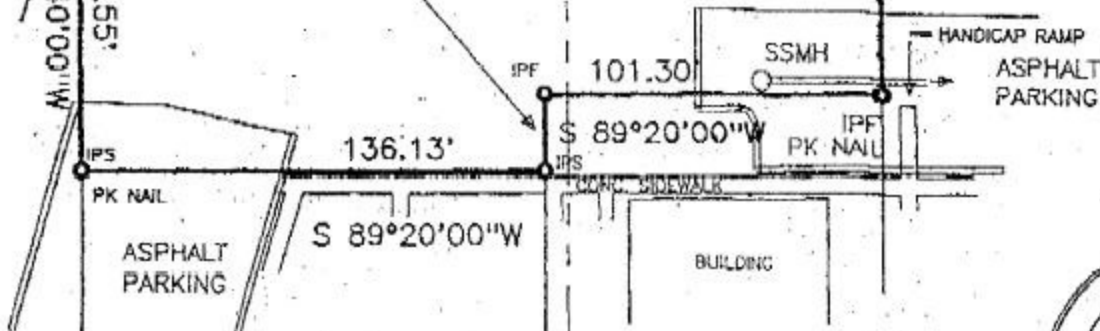
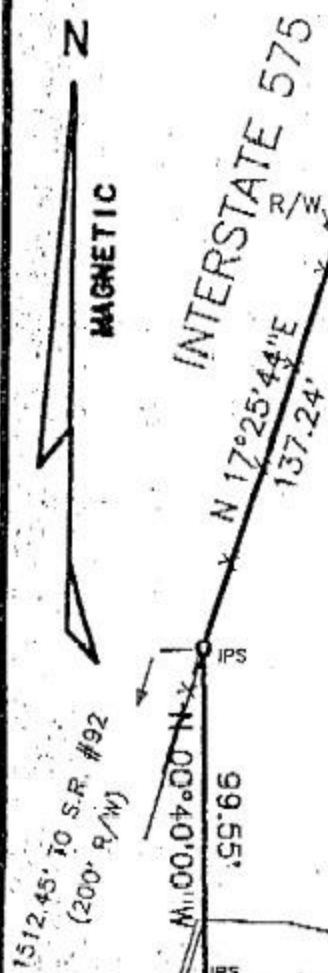

#4 REBARS @ CORNERS UNLESS OTHERWISE NOTED.

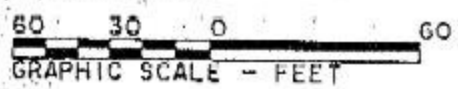

SURVEY AND PLAT

OF PROPERTY IN:
LAND LOT(S) 1162 & 1163
15 DISTRICT, 2ND SECTION
CHEROKEE COUNTY, GEORGIA

OCTOBER 21, 1998

SCALE: 1" = 60'

PREPARED BY:
HERNDON & BETTERTON, INC.
LAND SURVEYING/PLANNING
DEVELOPMENT DESIGN & SUPERVISION

1639 LOWER ROSWELL ROAD
MARIETTA, GEORGIA 30068
(770) 971-5079